



ALL BREED ASFA LURE COURSING TRIAL

Sunday, November 7, 2021

Lorain County Kennel Club

49949 OH-511
Oberlin, OH 44074

**In ASFA Region VI
ONE DAY PREMIUM LIST**

SEE SEPARATE PL FOR REGIONAL ON 11/6/2021

Early Entry Fee US Funds: \$20.00/ per hound. Day of trial entries \$25.00/per hound , close at 8 am at FTS desk on 11/7/2021. Early entries close on 11/3/21, 8 pm at FTS's address:

Gayle A. Kytta
1338 Red Bush Lane
Macedonia, Ohio, 44056.

A \$20 fee will be charged for any returned check.

LARK would like to thank the Lorain County Kennel Club for allowing us to use their facilities. Please be considerate and be sure to pick up after your dogs. Lets leave the grounds in the same clean condition they were when we arrived.

ASFA certification runs and practice will not be offered at this trial.



Permission has been granted by the American Sighthound Field Association for the holding of this event under ASFA Rules and Regulations.

Audrey Silverstein, Chairperson
ASFA Scheduling Committee

LARK Officers: President - Carl Morgan, Vice President - Paul Kytta II, Treasurer - Gayle Kytta, Recording/Corresponding Secretary - Jenn Miller, Board Members— Kaleena Lowther, Teri Timm-Miller, Judy Lowther, ASFA Delegate - Paul Kytta II

Judges (* = provisional judge, # = Canadian judge, S = Single judge)

John Arvin, Barnegat, NJ
Judy Lowther, Cleveland, OH
Don White, Grove City, OH

Saturday	AF	AZ	BA	B	CD	G	IB	IW	IG	P	RR	SD	Sa	SL	SW	W	Sin	Pvl
.John A.															S	S	S	S
Judy L								S	S	S	S	S	S	S				
Don W.	S	S	S	S	S	S	S											

Trial Chairperson: Paul Kytta II, 1338 Red Bush Lane, Macedonia, Ohio 44056
Cell: 330-348-9372 E-mail: kytta@roadrunner.com

Trial Secretary: Gayle Kytta, 1338 Red Bush Lane, Macedonia, Ohio, 44056
E-mail: gkytta@roadrunner.com Cell 330-338-8617
No entries accepted by e-mail or fax per ASFA rules. Make check payable to "LARK", US Funds.
Running orders to be determined morning of the trail.
Lure Operators: Don White, Carl Morgan, Jarret Teamer, John Arvin

Huntmasters: Paul Kytta II, Don White, Jarret Teamer, John Arvin

Trial Hours: 7:30 am until completion.

Roll Call & Inspection for all breeds: 8:30 AM Eastern Time. Worker's dogs may be roll called early.

Late, incomplete, conditional, unsigned, unpaid entries and entries without a registration number will NOT be accepted. Entries will NOT be acknowledged by mail. Substitutes for lame or in-season hounds will be allowed if substitute has the same owner and the trial secretary is notified before the close of day-of-trial entries.

Rosettes will be offered by LARK for: BIF—Red, White, and Blue, BOB—Purple and Gold, First—Blue, Second—Red, Third—yellow, Fourth—White, NBQ—Green. High scoring single—Navy and gold.

Only purebred Afghan Hounds, Azawakhs, Basenjis, Borzoi, Cirnecho dell'Etna, Greyhounds, Ibizan Hounds, Irish Wolfhounds, Italian Greyhounds, Pharaoh Hounds, Rhodesian Ridgebacks, Salukis, Scottish Deerhounds, Silken Windhounds, Sloughis, Whippets and Provisional breeds may be entered in the regular stakes. Current Provisional breeds include purebred Chart Polski, Galgo Espanol, Magyar Agar, Peruvian Inca Orchid, Portuguese Podengo (Pequeno), and Portuguese Podengo (Medio & Grande), and must be individually registered with the appropriate registry. Provisional breeds are not eligible for Best In Field.

All entries shall be individually registered with the AKC (ILP/PAL included), the NGA, the UKC, the FCI, an ASFA-recognized foreign or ASFA Board approved registry, or possess a CRN from the SPDBS. A photocopy of acceptable registry must be submitted with each hound's first ASFA field trial entry; this requirement is waived for hounds registered with the NGA.

Regular Stakes Offered

OPEN STAKE: Any eligible sighthound who has met certification requirements, excluding ASFA Field Champions of record. A photocopy of the hound's registration must be submitted at the hound's first trial. This is waived for NGA greyhounds

FIELD CHAMPION STAKE: Any ASFA Field Champion of record.

VETERAN STAKE: Any eligible hound whose age is at least six years, except Irish Wolfhounds, whose age shall be at least five years, and Afghan Hounds, Rhodesian Ridgebacks, Salukis and Whippets whose age shall be at least seven years and that have met certification requirements. Points earned in this stake are towards the V-FCH or V-LCM titles.

SINGLES STAKE: Any eligible sighthound including novice hounds and hounds with breed disqualifications and/or hounds that have been disqualified from competition in other stakes, are eligible to enter. Hounds are eligible to earn TCP and CPX titles from the Singles Stake. Provisional Breeds are not eligible for these titles. Not eligible for Best of Breed or Best In Field.

PROVISIONAL STAKE: Any eligible hound of a Provisional breed that has met certification requirements. Not eligible for Best In Field.

Conditions of Entry: All entries must be one year or older on the day of the trial. If the entry in any regular stake is 20 or more, the stakes will be split into flights by public random draw Bitches in season, lame hounds and hounds with breed disqualifications will be excused at roll call. Spayed, neutered, monorchid or cryptorchid hounds without breed disqualifications may be entered; hounds with breed disqualifications are not eligible to enter except in the Single Stake. Hounds not present at the time of roll call will be scratched. All hounds will run twice, in trios if possible or braces (except in the Single Stake), unless excused, dismissed or disqualified. Hound certification runs will be offered after completion of the trial on Saturday.

There will be a \$5.00 fine for any loose hounds on the field which are not in the course in progress. There will also be a \$5.00 fine for any one who does not pick up after their dog.

A battery powered CONTINUOUS LOOP lure machine will be used; backup equipment will be available. Lure will consist of highly visible plastic. The club reserves the right to alter the course as required by weather and/or field condition on the day of the trial. Courses will be reversed for finals, run-offs and again for BOB. The field is not fenced, but the course is well away from the main road.

Sunday Course Plan
625 yards

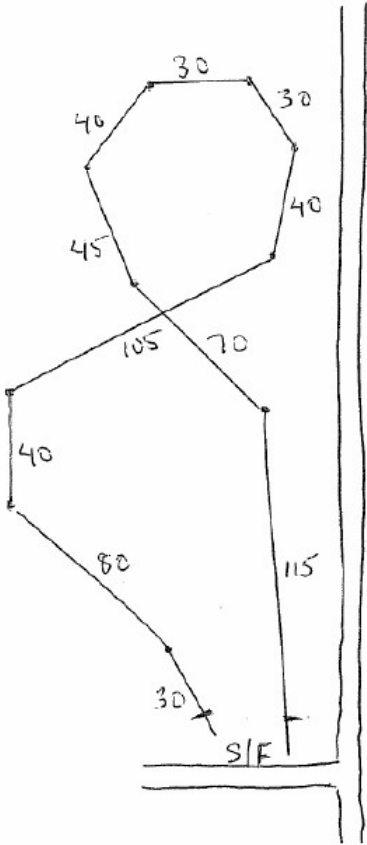

.....HOTELS AND CAMPING.....

Please be respectful of these properties and clean up after your dogs.

Please check with hotels for current pet policies:

Quality Inn - Elyria.....	(440) 324-7676
Super 8 Cleveland, N. Ridgeville	(440) 327-0500
Super 8 Elyria	(440) 323-7488
LaQuinta Cleveland Airport, N. Olmsted	(440) 734-4477
Red Roof Inn, Elyria	(440) 324-4444

Dry Camping is available on site for \$30 for the weekend (no hookups available). Please leave your campsite as clean as when you arrived. Heavy vehicle please be sure to park ONLY ON GRAVEL DRIVES.

.....FOOD.....

Lunch will not be provided, please bring your own food and water

.....DIRECTIONS.....

Traffic alert: From the Ohio Turnpike/I-80 do NOT take the Baumhart Rd exit. The intersection of Baumhart and OH-113 is closed. Take the exit east of it-exit 140 to OH-58. After exiting the turnpike go left (south) on OH-58 (Leavitt Rd), go 5.8 miles. This takes you into Oberlin. Go right (west) on Oh-511 (Lorain St) 4 miles. The field is on the left side a mile after you cross Baumhart Rd.

.....Emergency Vet Information.....

24 Hour Veterinarian Service:

Emergency Vet Services

Animal Clinic Northview
36400 Center Ridge Road
North Ridgeville, Ohio 44039
440-327-8282

See FTS for direction.

OFFICIAL AMERICAN SIGHTHOUND FIELD ASSOCIATION ENTRY FORM

Lorain Area Racing Klub Sunday, November 7, 2021

All Entry Fees US Funds: Early entry \$20.00/per hound. closes 11/3/2021, 8 pm at FTS's address. Day of trial \$25.00/per hound closes 8 am 11/7/2021 at FTS desk. Make check payable to LARK and mail to:

Gayle A. Kytta, LARK FTS
1338 Red Bush Lane
Macedonia, Ohio 44056

Fee Paid _____ The Field Secretary cannot accept conditional, unsigned, incomplete or unpaid entries; please check your completed entry carefully.

Breed:	Call Name:		
Registered Name of Hound:			
Stake: <input type="checkbox"/> Open <input type="checkbox"/> FCH <input type="checkbox"/> Veteran <input type="checkbox"/> Single <input type="checkbox"/> Provisional		Additional Stakes <input type="checkbox"/> Kennel <input type="checkbox"/> Breeder <input type="checkbox"/> Bench	
Registration Number: (please write in registering body before number)			
<input type="checkbox"/> If possible, please separate my hounds	Date of Birth:	Sex: <input type="checkbox"/> Dog <input type="checkbox"/> Bitch	
Name of actual owner(s):			
Address:		Phone:	
City:	State:	Zip:	
E-mail (Optional)		(Optional) Region of Residence:	
Emergency Contact Name and Phone (Optional)			
<input type="checkbox"/> Check if this is the first ASFA trial for this hound. Attach a Hound Certification or waiver if entered in Open, Veterans, Limited. <input type="checkbox"/> Check if this is a first-time entry, a copy of the official Registration of this hound must accompany this entry unless NGA.			
<input type="checkbox"/> Check if any information has changed since the last ASFA trial entry. Regarding _____			
<input type="checkbox"/> Check if this hound has been dismissed within the last 6 trials entered. Must be marked in order to qualify for a "clean" trial requirement.			

I CERTIFY that I am the actual owner of this dog, or that I am the duly authorized agent of the actual owner whose name I have entered above. In consideration of the acceptance of this entry and the opportunity to have this dog judged and to win prize money, ribbons, or trophies, I (we) agree to abide by the rules and regulations of the American Sighthound Field Association in effect at the time of this lure field trial, and by any additional rules and regulations appearing in the premium list for this lure field trial. I (we) agree that the club holding this lure field trial has the right to refuse this entry for cause, which the club shall deem to be sufficient. I (we) agree to hold this club, its members, directors, governors, officers, agents or other functionaries, any employees of the aforementioned parties and the owner(s) of the trial premises or grounds harmless from any claim for loss or injury which may be alleged to have been caused directly or indirectly to any person or thing by the act of this dog while in or upon the lure field trial premises or grounds or near any entrance thereto and I (we) personally assume all responsibility and liability for any such claim, and I (we) further agree to hold the aforementioned parties harmless from any claim loss of this dog by disappearance, theft damage or injury be caused or alleged to be caused by the negligence of the club or any of the aforementioned parties or by the negligence of any person or any other cause or causes. I (we) certify and represent that the dog entered is not a hazard to person or other dogs. This entry is submitted for acceptance of the forgoing representations and agreements.

SIGNATURE of owner or his agent
duly authorized to make this entry _____

Please separate the entries before submitting to FTS.

OFFICIAL AMERICAN SIGHTHOUND FIELD ASSOCIATION ENTRY FORM

Lorain Area Racing Klub Sunday, November 7, 2021

All Entry Fees US Funds: Early entry \$20.00/per hound. closes 11/3/2021, 8 pm at FTS's address. Day of trial \$25.00/per hound closes 8 am 11/7/2021 at FTS desk. Make check payable to LARK and mail to:

Gayle A. Kytta, LARK FTS
1338 Red Bush Lane
Macedonia, Ohio 44056

Fee Paid _____ The Field Secretary cannot accept conditional, unsigned, incomplete or unpaid entries; please check your completed entry carefully.

Breed:	Call Name:		
Registered Name of Hound:			
Stake: <input type="checkbox"/> Open <input type="checkbox"/> FCH <input type="checkbox"/> Veteran <input type="checkbox"/> Single <input type="checkbox"/> Provisional		Additional Stakes <input type="checkbox"/> Kennel <input type="checkbox"/> Breeder <input type="checkbox"/> Bench	
Registration Number: (please write in registering body before number)			
<input type="checkbox"/> If possible, please separate my hounds	Date of Birth:	Sex: <input type="checkbox"/> Dog <input type="checkbox"/> Bitch	
Name of actual owner(s):			
Address:		Phone:	
City:	State:	Zip:	
E-mail (Optional)		(Optional) Region of Residence:	
Emergency Contact Name and Phone (Optional)			
<input type="checkbox"/> Check if this is the first ASFA trial for this hound. Attach a Hound Certification or waiver if entered in Open, Veterans, Limited. <input type="checkbox"/> Check if this is a first-time entry, a copy of the official Registration of this hound must accompany this entry unless NGA.			
<input type="checkbox"/> Check if any information has changed since the last ASFA trial entry. Regarding _____			
<input type="checkbox"/> Check if this hound has been dismissed within the last 6 trials entered. Must be marked in order to qualify for a "clean" trial requirement.			

I CERTIFY that I am the actual owner of this dog, or that I am the duly authorized agent of the actual owner whose name I have entered above. In consideration of the acceptance of this entry and the opportunity to have this dog judged and to win prize money, ribbons, or trophies, I (we) agree to abide by the rules and regulations of the American Sighthound Field Association in effect at the time of this lure field trial, and by any additional rules and regulations appearing in the premium list for this lure field trial. I (we) agree that the club holding this lure field trial has the right to refuse this entry for cause, which the club shall deem to be sufficient. I (we) agree to hold this club, its members, directors, governors, officers, agents or other functionaries, any employees of the aforementioned parties and the owner(s) of the trial premises or grounds harmless from any claim for loss or injury which may be alleged to have been caused directly or indirectly to any person or thing by the act of this dog while in or upon the lure field trial premises or grounds or near any entrance thereto and I (we) personally assume all responsibility and liability for any such claim, and I (we) further agree to hold the aforementioned parties harmless from any claim loss of this dog by disappearance, theft damage or injury be caused or alleged to be caused by the negligence of the club or any of the aforementioned parties or by the negligence of any person or any other cause or causes. I (we) certify and represent that the dog entered is not a hazard to person or other dogs. This entry is submitted for acceptance of the forgoing representations and agreements.

SIGNATURE of owner or his agent
duly authorized to make this entry _____

Please separate the entries before submitting to FTS.